

MODEL: PFTX 2500-3

Nozzle Loadings

Maximum Allowable Load on Outlet & Return Nozzles				
	30# Design	60# Design	125# Design	160# Design
FRRF, lb	6,570	4,400	11,495	24,695
MRCM, in-lb	73,145	73,145	252,720	352,760
MRLM, in-lb	104,275	69,825	208,555	451,605

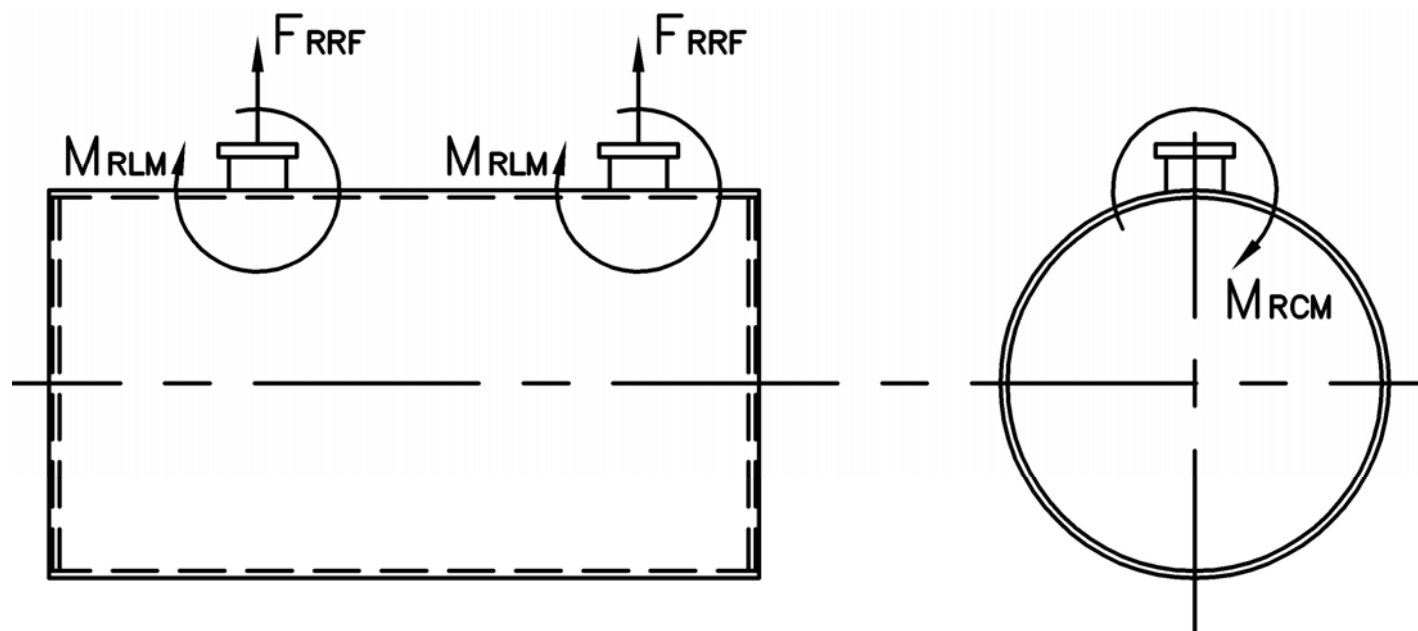

Distributed By:



300 Pine Street
P.O. Box 300
Ferrysburg, MI 49409-0300
Telephone: (616) 842-5050
Net: www.johnstonboiler.com

MODEL: PFTX 2500-3

3-Pass Hot Water Packaged Firetube Boiler



Ratings & Performance Data

Horsepower 2500		Natural Gas Flow, SCFH (1,000 Btu/ft ³)**	98,018
Total Heating Surface, ft ²	9,926	Combustion Air (15% Excess), SCFM***	17,936
Furnace Outside Diameter, in	66.5	Flue Gas Flow Rate, lb/hr***	85,477
Furnace Heat Release Rate, Btu/ft ³ hr**	225,000	Stack Flue Gas Velocity, ft/min***	2,355
Total Combustion Volume, ft ³	627.9	#2 Oil Flow, gal/hr (140,000 Btu/gal)**	676.3
Total Heat Release Rate, Btu/ft ³ hr**	156,000	#6 Oil Flow, gal/hr (150,000 Btu/gal)**	626.7
Water Content Flooded, gal	11,188	Flue Gas Side Pressure Drop, in. H ₂ O	3.6
Approx. Dry Weight 30#, lb	107,200	Approx. Operating Weight 30#, lb	202,400
Approx. Dry Weight 60#, lb	112,000	Approx. Operating Weight 60#, lb	207,200
Approx. Dry Weight 125#, lb	116,500	Approx. Operating Weight 125#, lb	211,700

Operating Temperature (F)	Natural Gas		#2 Oil		#6 Oil	
	Stack Temp (F)	%Eff	Stack Temp	%Eff	Stack Temp (F)	%Eff
180	257	85.8	272	88.8	283	89.5
200	276	85.4	291	88.4	302	89.0
220	295	84.9	310	87.9	321	88.6
240	315	84.5	329	87.5	340	88.1

*Based on 20°F difference in supply/return, ** Values calculated at 200°F operating temperature, ***Calculated Firing Natural Gas

